

# HID ignitors for series systems

## SI 51 220-240V 50/60Hz

HID ignitors for series systems

### Product data

| General Information                       |                           |
|---|---------------------------|
| Application Code                          | 51                        |
| Lamp Type                                 | HPI                       |
| Number of Lamps                           | 1 piece/unit              |
| Operating and Electrical                  |                           |
| Input Voltage                             | 220 to 240 V              |
| Input Frequency                           | 50 to 60 Hz               |
| Igniton Type                              | Parallel                  |
| Number of Ignition Pulses                 | 1                         |
| Ignition Voltage (Max)                    | 0.75 kV                   |
| Response Voltage                          | 190 V                     |
| Mains Voltage Performance (AC)            | -8% - +6%                 |
| Mains Voltage Safety (AC)                 | -10% - +10%               |
| Power Losses (Nom)                        | 1.0 W                     |
| Wiring                                    |                           |
| Cable Capacity Wires Device to Lamp (Nom) | 150 nF                    |
| Wire Striplength                          | 6.0 mm                    |
| Ballast Contact Wire Cross Section        | 0.70-2.50 mm <sup>2</sup> |
| Connector Type                            | Screw                     |

| System characteristics          |                             |
|---------------------------------|-----------------------------|
| Rated Ballast-Lamp Power        | 250/400 W                   |
| Temperature                     |                             |
| T-Ambient (Max)                 | 75 °C                       |
| T-Ambient (Min)                 | -20 °C                      |
| T-Storage (Max)                 | 80 °C                       |
| T-Storage (Min)                 | -25 °C                      |
| T-Case Maximum (Max)            | 80 °C                       |
| Mechanical and Housing          |                             |
| Housing                         | SNI-85                      |
| Approval and Application        |                             |
| Approval Marks                  | CE marking ENEC certificate |
| Product Data                    |                             |
| Full product code               | 871150091553530             |
| Order product name              | SI 51 220-240V 50/60Hz      |
| EAN/UPC - Product               | 8711500915535               |
| Order code                      | 913619519966                |
| Numerator - Quantity Per Pack   | 1                           |
| Numerator - Packs per outer box | 48                          |

## HID ignitors for series systems

|                     |              |
|---------------------|--------------|
| Material Nr. (12NC) | 913619519966 |
| Net Weight (Piece)  | 0.047 kg     |

### Dimensional drawing

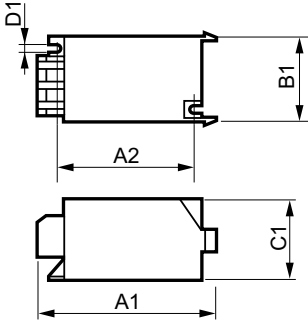

SI 51 220-240V 50/60Hz

| Product                | D1     | C1      | A1      | A2      | B1      |
|------------------------|--------|---------|---------|---------|---------|
| SI 51 220-240V 50/60Hz | 4.3 mm | 38.0 mm | 84.5 mm | 65.0 mm | 41.0 mm |

