



# HID ignitors for series systems

## SX 74 220-240V 50/60HZ

HID ignitors for series systems

### Product data

General Information	
Application code	74
Lamp type	SOX/SOX-E
Number of lamps	1 piece/unit
Operating and Electrical	
Input voltage	220 to 240 V
Input frequency	50 to 60 Hz
Ignition type	Parallel
Ignition voltage (max.)	1.4 kV
Response voltage	198 V
Mains voltage performance (AC)	-8% - +6%
Mains voltage safety (AC)	-10% - +10%
Power losses (nom.)	1.0 W
Wiring	
Cable capacity wires device to lamp (nom.)	2 nF
Wire strip length	6.0 mm
Ballast contact wire cross section	0.70-2.50 mm <sup>2</sup>
Connector type	Screw

System characteristics	
Rated ballast-lamp power	91/135 W
Temperature	
T ambient (max.)	75 °C
T ambient (min.)	-20 °C
T storage (max.)	80 °C
T storage (min.)	-25 °C
T-Case maximum (max.)	80 °C
Mechanical and Housing	
Housing	SNI-115
Approval and Application	
Approval marks	CE marking ENEC certificate
Product Data	
Full product code	871150091569630
Order product name	SX 74 220-240V 50/60Hz
EAN/UPC – product	8711500915696
Order code	91569630
Local Code	SX74
Numerator – quantity per pack	1

## HID ignitors for series systems

Numerator – packs per outer box	20
Material no. (12NC)	913654079066
Net weight (piece)	0.090 kg

### Dimensional drawing

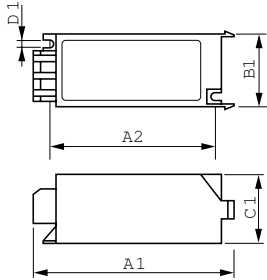

SX 74 220-240V 50/60Hz

### Product

SX 74 220-240V 50/60Hz

