

PHILIPS

Lighting

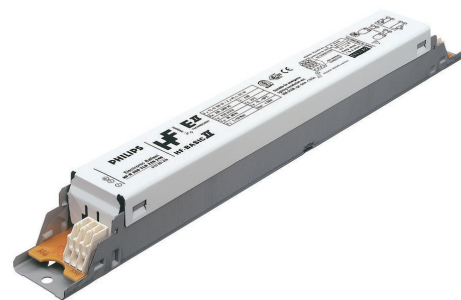

HF-Basic II for TL-D lamps

HF-B 136/236 TL-D EII 220-240V 50/60Hz

Affordable, reliable, CE complying, high frequency electronic ballast for TLD fluorescent lamps Ideal alternative for electromagnetic (EM) ballasts

Product data

General Information

| | |
|--|--------------|
| Application Code | EII |
| Type Version | mk1 |
| Lamp Type | TL-D |
| Number of Lamps | 2 piece/unit |
| Number of Products on MCB (16A Type B) (Nom) | 28 |
| Automatic Restart | Yes |

Operating and Electrical

| | |
|--------------------------------|--------------|
| Input Voltage | 220 to 240 V |
| Input Frequency | 50 to 60 Hz |
| Operating Frequency (Max) | - kHz |
| Operating Frequency (Min) | 42 kHz |
| Operating Frequency (Nom) | 45 kHz |
| Ignition Method | Cold Start |
| Crestfactor (Max) | 1.7 |
| Power Factor 100% Load (Nom) | 0.96 |
| Ignition Time (Max) | 0.5 s |
| Mains Voltage Performance (AC) | -8% - +6% |
| Mains Voltage Safety (AC) | -10% - +10% |
| Earth Leakage Current (Nom) | 0.5 mA |

| | |
|----------------------------|---------|
| Inrush Current Width | 0.25 ms |
| Constant Wattage Deviation | -2%/+2% |
| Ballast Factor (Nom) | 0.95 |
| Power Losses (Nom) | 4.0 W |
| Inrush Current Peak (Max) | 18 A |

Wiring

| | |
|--|--|
| Connector Type Input Terminals | WAGO 251 universal connector [Suitable for both automatic wiring (ALF and ADS) and manual wiring] |
| Cable Capacity Output Wires Mutual (Nom) | 120 pF |
| Connector Type Output Terminals | WAGO 251 universal connector [Suitable for both automatic wiring (ALF and ADS) and manual wiring] |
| Cable Length From Device to Lamp | 2.00 m |
| Cable Length Hot Wiring | 0.75 m |
| Wire Striplength | 8.0-9.0 mm |
| Dual Fixture Master/Slave | Yes [Master/Slave operation possible] |
| Input Terminal Cross Section | 0.50-1.00 mm ² |
| Output Terminal Cross Section | 0.50-1.00 mm ² |
| Auto Insert (ALF/ADS) Wire Cross Section | 0.5 mm ² |
| Cable Capacity Output Wires to Earth (Nom) | 120 pF |

HF-Basic II for TL-D lamps

System characteristics

| | |
|--------------------------|--------|
| Rated Ballast-Lamp Power | 36 W |
| Rated Lamp Power on TL-D | 36 W |
| System Power on TL-D | 36.5 W |
| Lamp Power on TL-D | 32 W |
| Power Loss on TL-D | 4.5 W |

Temperature

| | |
|-----------------------|--------|
| T-Ambient (Max) | 50 °C |
| T-Ambient (Min) | -15 °C |
| T-Storage (Max) | 80 °C |
| T-Storage (Min) | -40 °C |
| T-Case Lifetime (Nom) | 75 °C |
| T-Case Maximum (Max) | 75 °C |
| T-Ignition (Max) | 50 °C |
| T-Ignition (Min) | -15 °C |

Mechanical and Housing

| | |
|---------|--------------------|
| Housing | - [Not Specified] |
|---------|--------------------|

Emergency Operation

| | |
|--------------------------------|-----------|
| Battery Voltage Lamp Ignition | 198-254 V |
| Battery Voltage Lamp Operation | 176-254 |

Approval and Application

| | |
|-------------------------|-----------------|
| Energy Efficiency Index | A2 |
| EMI 9 kHz ... 30 MHz | EN55015 |
| EMI 30 MHz ... 1000 MHz | EN55022 level A |

| | |
|------------------------------------|---|
| Safety Standard | IEC 61347-2-3 |
| Performance Standard | IEC 60929 |
| Quality Standard | ISO 9000:2000 |
| Environmental Standard | ISO 14001 |
| Harmonic Current Emission Standard | IEC 61000-3-2 |
| EMC Immunity Standard | IEC 61547 |
| Vibration Standard | IEC68-2-6 F c |
| Bumps Standard | IEC 68-2-29 Eb |
| Humidity Standard | EN 61347-2-3 clause 11 |
| Approval Marks | CE marking ENEC certificate VDE-EMV certificate |
| Temperature Marking | Yes |
| Emergency Standard | IEC 60598-2-22 |
| Hum And Noise Level | Inaudible |

Product Data

| | |
|---------------------------------|--|
| Full product code | 871150093158030 |
| Order product name | HF-B 136/236 TL-D EII 220-240V 50/60Hz |
| EAN/UPC - Product | 8711500931580 |
| Order code | 913700192866 |
| Numerator - Quantity Per Pack | 1 |
| Numerator - Packs per outer box | 12 |
| Material Nr. (12NC) | 913700192866 |
| Net Weight (Piece) | 0.215 kg |

Dimensional drawing

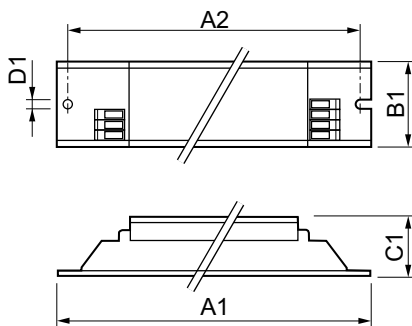

HF-B 236 TL-D EII 220-240V 50/60Hz

| Product | D1 | C1 | A1 | A2 | B1 |
|--|--------|---------|----------|----------|---------|
| HF-B 136/236 TL-D EII 220-240V 50/60Hz | 4.2 mm | 28.0 mm | 280.0 mm | 265.0 mm | 30.0 mm |

HF-Basic II for TL-D lamps

